

FINISH, EQUIPMENT & ACCESSORIES SCHEDULE:

CODE	DESCRIPTION	MANUFACTURER	STYLE	COLOR	SIZE	COMMENTS	CONTACT
FLOORS							
C-1	SEALED CONCRETE	LOCAL	-	CLEAR	-	RE-SEAL EXISTING SEALED CONCRETE FLOORING AS NECESSARY	-
BASE							
WB-1	APPLIED WOOD BASE	STOCK LUMBER	SQUARE PROFILE	PAINTED, P-1 U.N.O	3/4" x 6"	MITER ALL JOINTS & CORNERS USE SEMI-GLOSS SHEEN	-
WALLS							
P-1	PAINT	SHERWIN WILLIAMS	SW 7006	EXTRA WHITE	N/A	FINISH: FLAT @ CEILINGS, EGGSHELL @ WALLS	BRETT HUCKELBURY bhuckelbury@sherwin.com - 214-553-3940
T-1	CERAMIC TILE	ARIZONA TILE	CORE	WHITE	3" x 6"	GROUT: LATICRETE BRIGHT WHITE	BETTY ANNA YARBOROUGH byarbrough@arizonatile.com - 972-456-0935
MR-1	MIRROR	MIRROR IMAGE HOSPITALITY	ANTIQUUE MIRRORS VERSION 7.13	C07 SAPHIRE	CUSTOM	REFER ELEVATION 034-700	-
WC-1	WALLCOVERING	TENANT PROVIDED	-	-	-	TENANT PROVIDED, CONTRACTOR INSTALLED	-
WD-1	APPLIED WOOD MOSAIC	TENANT PROVIDED	-	-	-	TENANT PROVIDED, CONTRACTOR INSTALLED	-
MILLWORK							
QS-1	QUARTZ SURFACE	DUPONT	ZODIAC QUARTZ SURFACE	SNOW WHITE	3/4"	-	ALLISON BAKER abaker@hmark.com - 817-929-7072
PL-1	PLASTIC LAMINATE	WILSONART	STANDARD LAMINATE	FROSTY WHITE 1573-60	-	MATTE FINISH	LISA PORTILLO portill@wilsonart.com - 214-634-2310
EQUIPMENT & ACCESSORIES							
E1	TRASH RECEPTACLE	MCMaster-CARR	4089T2	GRAY	15-1/4" x 11" x 20" (10 GALLON)	-	-
E2	LAVATORY	KOHLER	RIVERBY K-5479-5U	0 WHITE	22" x 25" x 5-1/4"	UNDER-MOUNT	-
E3	FAUCET	KOHLER	MAZZ K-R72511-SD	CP POLISHED CHROME	-	DO NOT INSTALL SOAP / LOTION DISPENSER (INCLUDED) - TURN OVER TO TENANT	-
E4	UNDER-COUNTER REFRIGERATOR	TENANT PROVIDED	-	-	-	TENANT PROVIDED, CONTRACTOR INSTALLED	-
E5 / E6	STACKED WASHER / DRYER COMBO	TENANT PROVIDED	-	-	-	TENANT PROVIDED, CONTRACTOR INSTALLED	-
E7	COPY / FAX MACHINE	TENANT PROVIDED	-	-	-	TENANT PROVIDED, CONTRACTOR INSTALLED	-
E8	SHREDDER	TENANT PROVIDED	-	-	-	TENANT PROVIDED, CONTRACTOR INSTALLED	-
E9	RECESSED PAPER TOWEL DISPENSER	BOBRICK	B-35903	SATIN STAINLESS STEEL	-	MOUNT IN ACCORDANCE WITH TAS / ADA STANDARDS.	-

**NOTE: ADDITIONAL EQUIPMENT RELATED TO MEDICAL AESTHETICS NOT LISTED. GC TO COORDINATE QUANTITY AND INSTALL LOCATIONS WITH TENANT.

DOOR SCHEDULE:

DOOR	DOOR LOCATION	MODE	SIZE	DOOR TYPE	HARDWARE SET	DOOR MATERIAL	FRAME TYPE	FIRE RATING	PANIC HW	CLOSERS	REMARKS
103A1	STORAGE	SINGLE	3'-0" X 8'-0"	A	3	SC WOOD	ALUM	-	-	-	-
103A2	STORAGE	SINGLE	2'-6" X 8'-0"	C	2	SC WOOD	ALUM	-	-	-	-
103B	PATIENT ROOM	SINGLE	3'-4" X 8'-0"	B	1	SC WOOD	NONE	-	-	-	-
103C	PATIENT ROOM	SINGLE	3'-4" X 8'-0"	B	1	SC WOOD	NONE	-	-	-	-
103D	PATIENT ROOM	SINGLE	3'-4" X 8'-0"	B	1	SC WOOD	NONE	-	-	-	-
103E	LAB	SINGLE	3'-4" X 8'-0"	B	1	SC WOOD	NONE	-	-	-	-
103F	PATIENT ROOM	SINGLE	3'-0" X 8'-0"	A	4	SC WOOD	ALUM	-	-	-	-

HARDWARE SETS:

- HARDWARE SET NO. 1**
- PEMKO W100
 - POLISHED STAINLESS STEEL
 - 6-8" MINIMUM RAIL LENGTH, COORDINATE EXACT RAIL LENGTH WITH MANUFACTURER'S REQUIREMENTS
 - DOOR PULL DESIGN BASIS: ROCKWOOD MEZZOTEK 1-1/4" x 3/8" OR SIMILAR
- HARDWARE SET NO. 2**
- BUTT HINGES
 - STOPS
 - KEYPAD ENTRY WITH KEY OVERRIDE
- HARDWARE SET NO. 3**
- BUTT HINGES
 - OVERHEAD CLOSER AND STOP
 - STORAGE ROOM LOCKSET
- HARDWARE SET NO. 4**
- BUTT HINGES
 - WALL STOP
 - PASSAGE SET
- HARDWARE NOTE:**
- LOCKSET AND LEVER BY DOOR MANUFACTURER U.N.O.

DOOR NOTES:

1. IN ANY POSITION, THE DOOR MUST NOT REDUCE THE REQUIRED EXIT WIDTH BY MORE THAN HALF.
 2. DOORS, FRAMES & HARDWARE TO FORM FIRE-RATED ASSEMBLY AS REQUIRED FOR RATED ENCLOSURES FOR THIS PROJECT'S TYPE OF CONSTRUCTION.
 3. CONFIRM ALL HARDWARE FUNCTIONS AND FINAL KEYING WITH OWNER INCLUDING FUTURE EXPANSION, MASTER KEYING, REMOVABLE CORES, ETC.
 4. MOUNT DOOR CLOSER SO AS NOT TO BE VISIBLE FROM LOBBY OR CORRIDORS.
 5. PROVIDE RATED DOORS, FRAMES AND HARDWARE FOR ALL DOOR OPENINGS IN RATED WALLS AS NOTED IN DRAWINGS OR ON SCHEDULE. EXISTING RATINGS TO BE MAINTAINED.
 6. ALL HARDWARE AND HARDWARE INSTALLATION SHALL COMPLY WITH ALL FEDERAL, STATE AND LOCAL JURISDICTION REGULATIONS, AMERICANS WITH DISABILITIES ACT AND STATE OF TEXAS "TEXAS ACCESSIBILITY STANDARDS".
 7. ALL REQUIRED DOORS SHALL HAVE 32" MIN. CLEARANCE AT 90 DEGREES.
 8. THRESHOLDS SHALL BE NO HIGHER THAN 1/2" ABOVE THE FLOOR. EDGE TO BE BEVELED WITH A SLOPE NO GREATER THAN 1 IN 2, IF MORE THAN 1/4" ABOVE THE FLOOR.
 9. DOOR HARDWARE SHALL BE OF THE LEVER OR PUSH-PULL TYPE, HEIGHT ABOVE THE FLOOR TO COMPLY WITH AMERICANS WITH DISABILITIES ACT AND STATE OF TEXAS "TEXAS ACCESSIBILITY STANDARDS".
 10. EXIT DOORS TO BE OPERABLE FROM INSIDE WITHOUT USE OF A KEY OR ANY SPECIAL KNOWLEDGE OR EFFORT. NO DEADBOLTS, SLIDING BOLTS, ETC.
11. ACCESS CONTROL SYSTEM MUST NOT INTERFERE WITH EGRESS.

FRAME GENERAL NOTES:

1. CONFIRM ALL FRAMING REQUIREMENTS WITH THE INTERIOR ALUMINUM FRAME MANUFACTURER AND WITH THE SYSTEM USED. BULGING GYPSUM BOARD AT FRAMES IS NOT ACCEPTABLE.
2. ALL JOINTS IN FRAMING MATERIAL SHALL BE TIGHT (HAIRLINE) AND FLUSH WITH ADJACENT SURFACES.
3. INSTALL PLUMB, LEVEL, SQUARE, AND FREE FROM WARP OR TWIST WHILE MAINTAINING DIMENSIONAL TOLERANCES AND ALIGNMENT WITH ADJACENT WORK.

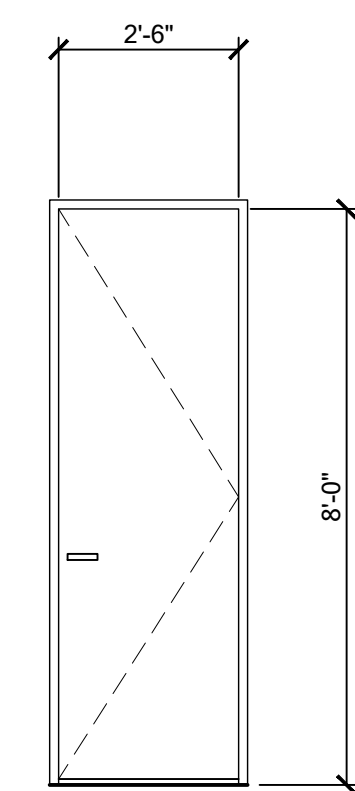

TYPE C
-SOLID CORE PLASTIC LAMINATE DOOR (PL-1)
-1 1/2" PRE-FINISHED ALUMINUM FRAME (PT-1)
-PROVIDE 1" UNDERCUT ON DOOR FOR VENTILATION

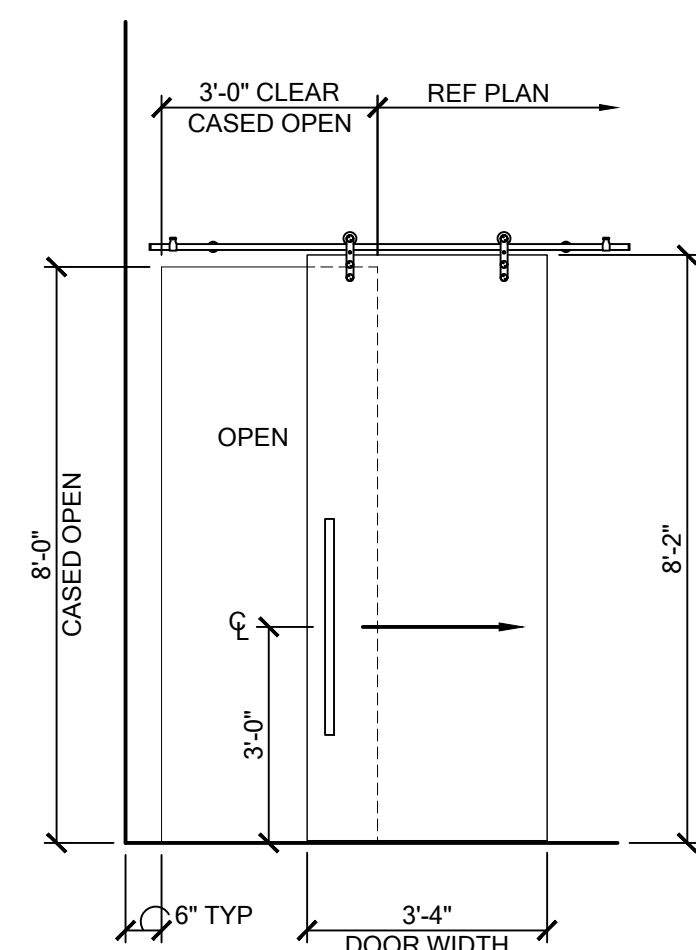

TYPE B
-SOLID CORE PLASTIC LAMINATE DOOR (PL-1)
-BACK TO BACK PULLS

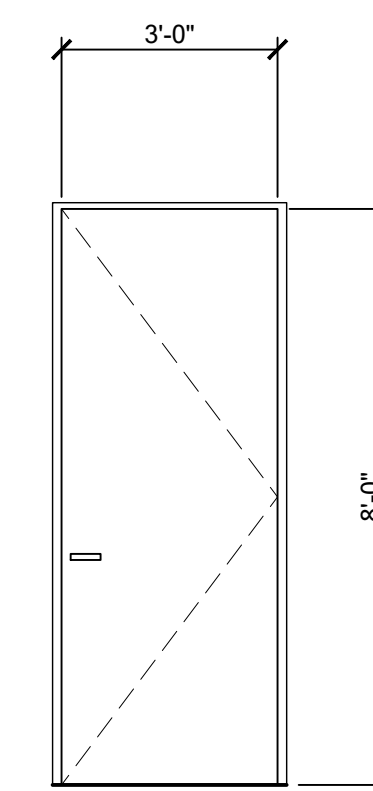

TYPE A
-SOLID CORE PLASTIC LAMINATE DOOR (PL-1)
-1 1/2" PRE-FINISHED ALUMINUM FRAME (PT-1)

09

TYPICAL DOOR TYPES

File Name: I-700.DWG

Scale: 3/8" = 1'-0"

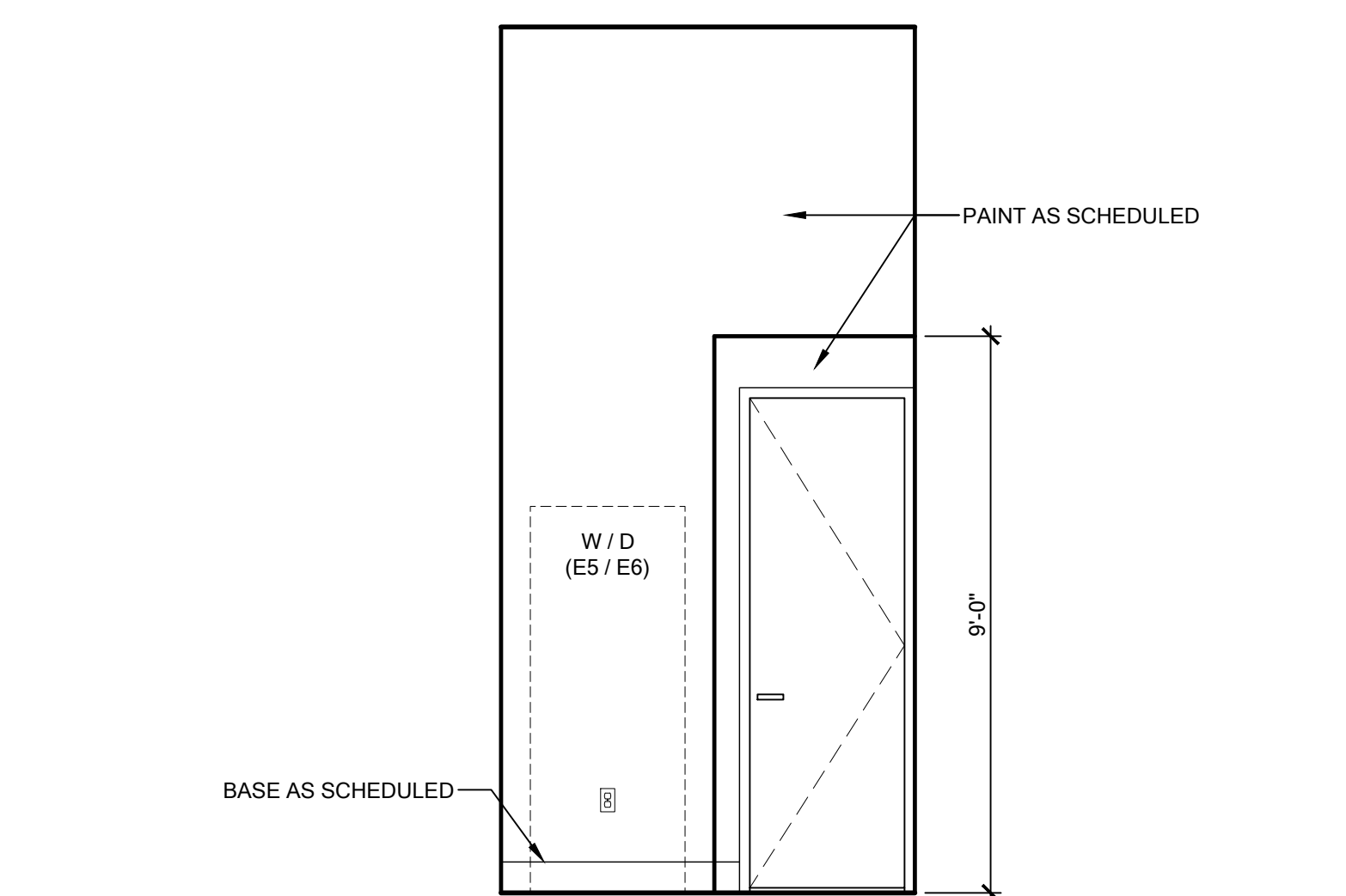

08 ELEVATION

File Name: I-700.DWG

SCALE: 3/8" = 1'-0"

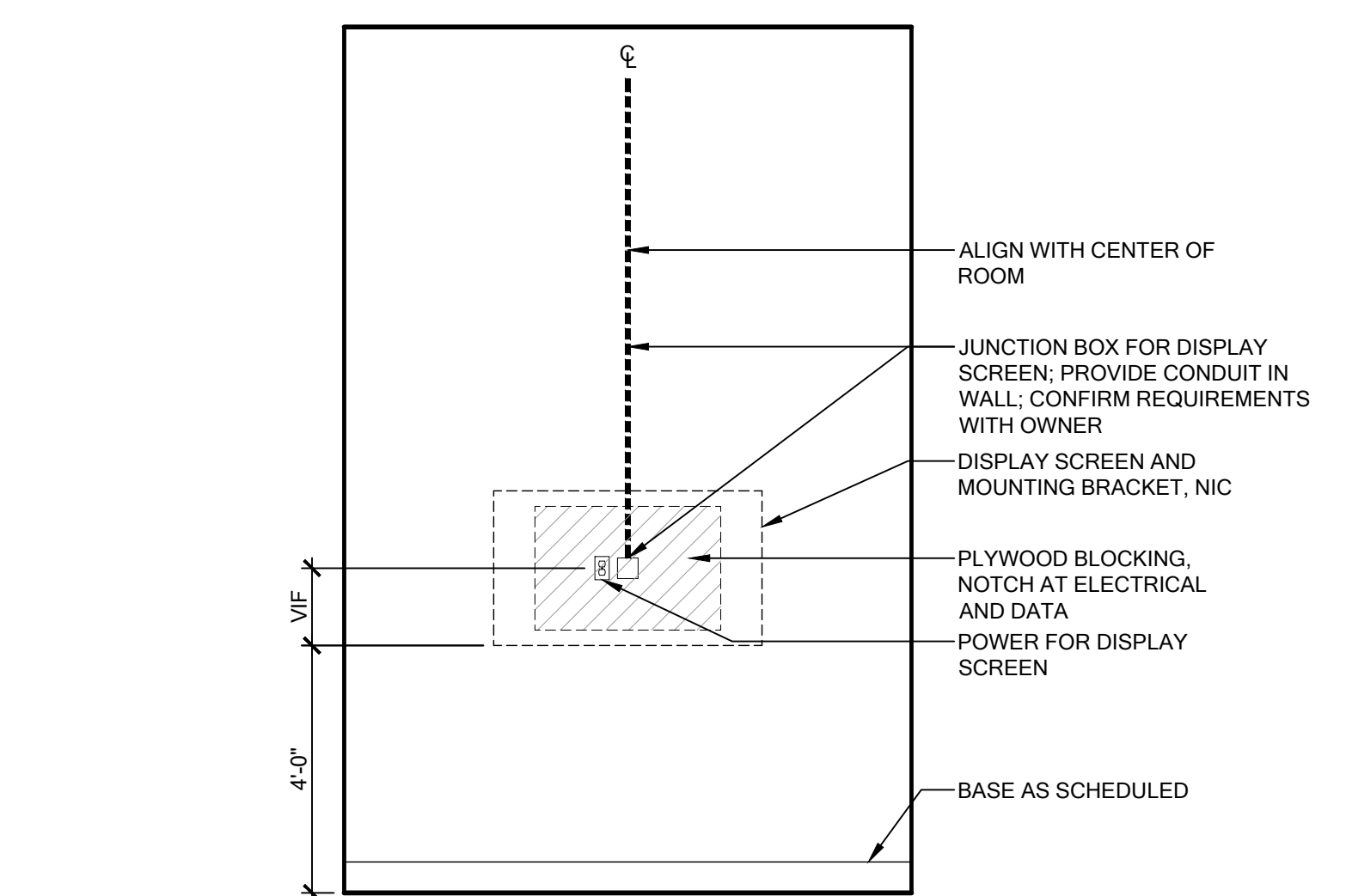

07 ELEVATION

File Name: I-700.DWG

SCALE: 3/8" = 1'-0"

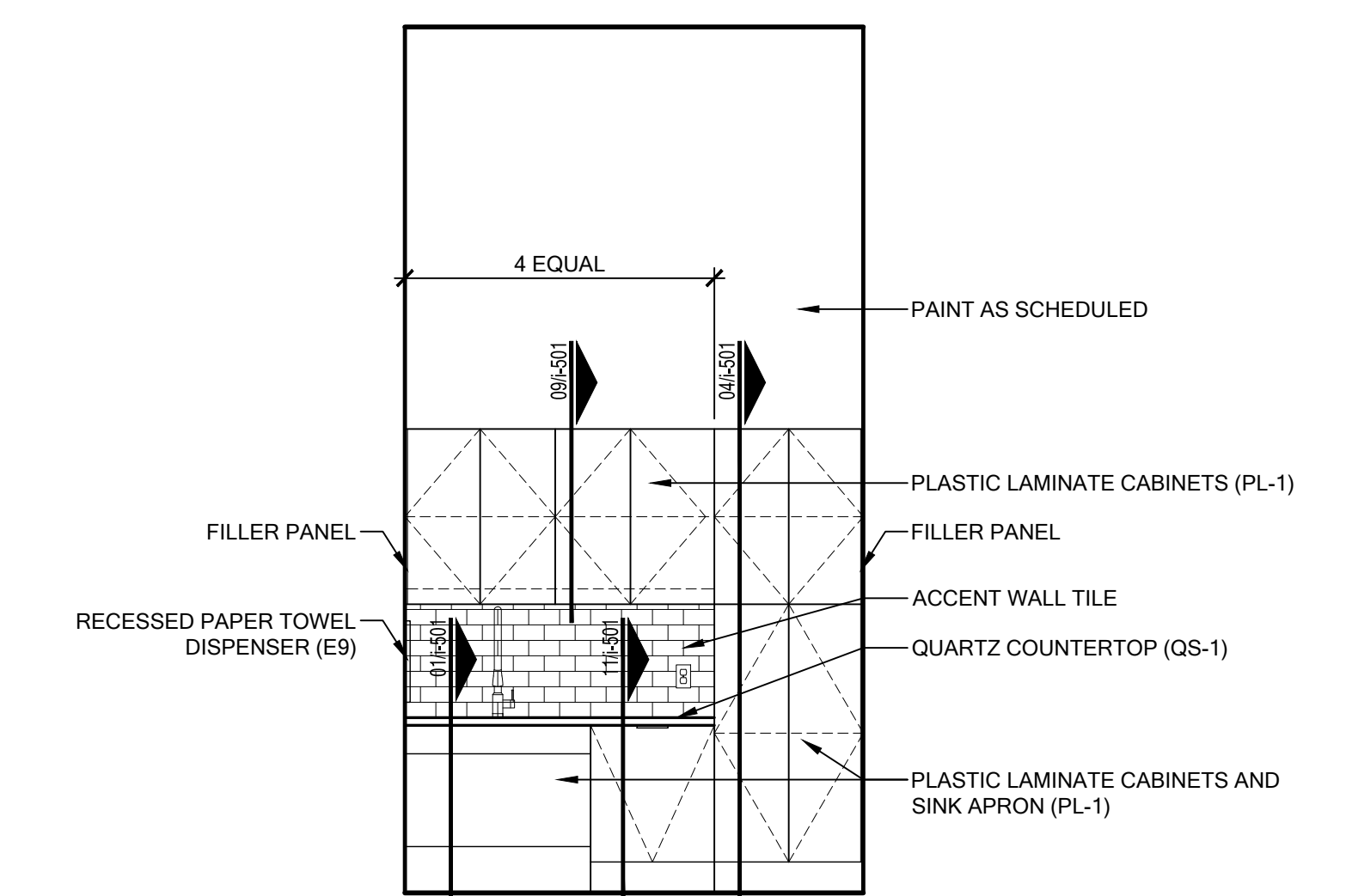

06 ELEVATION

File Name: I-700.DWG

SCALE: 3/8" = 1'-0"

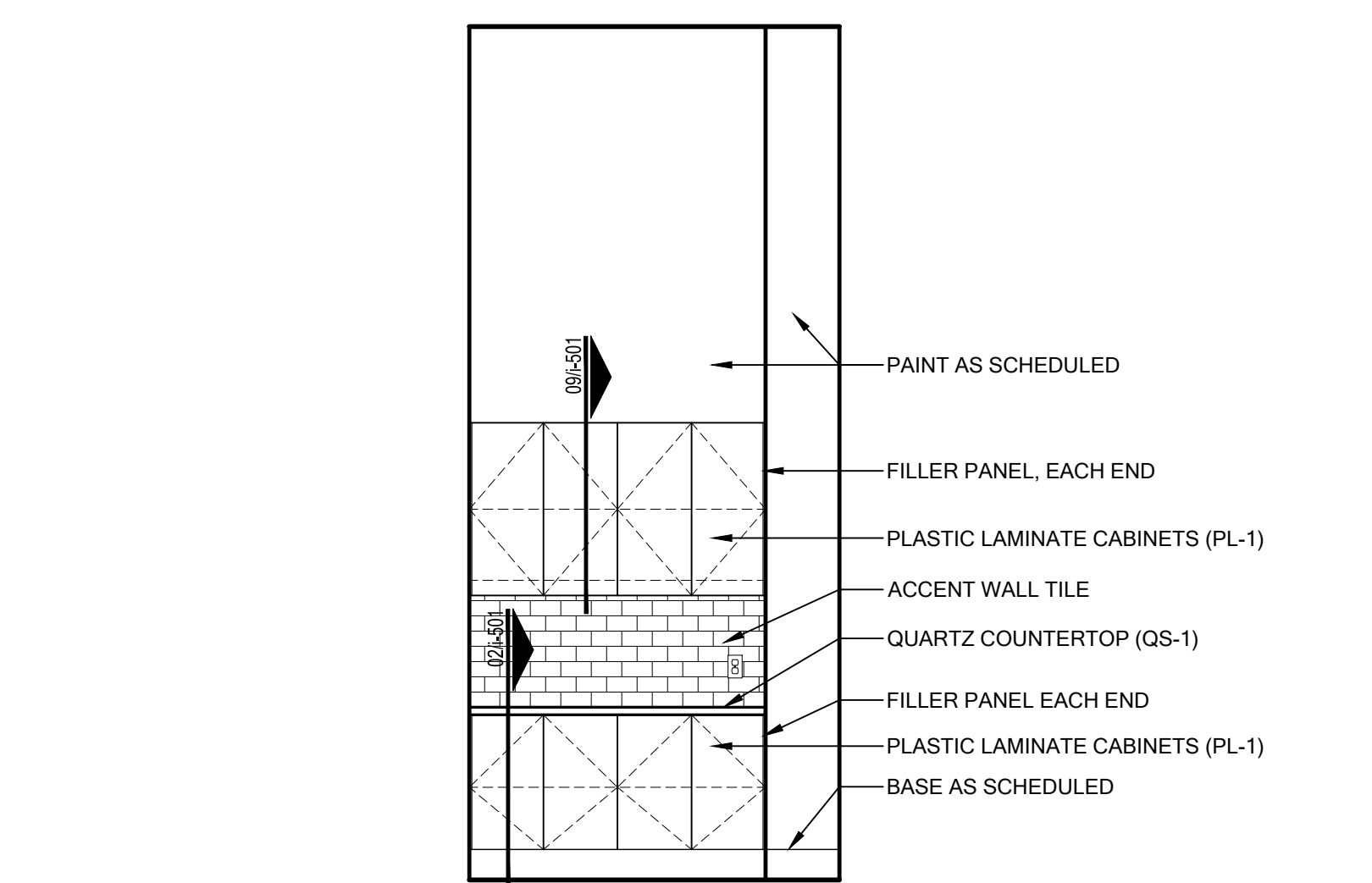

05 ELEVATION

File Name: I-700.DWG

SCALE: 3/8" = 1'-0"

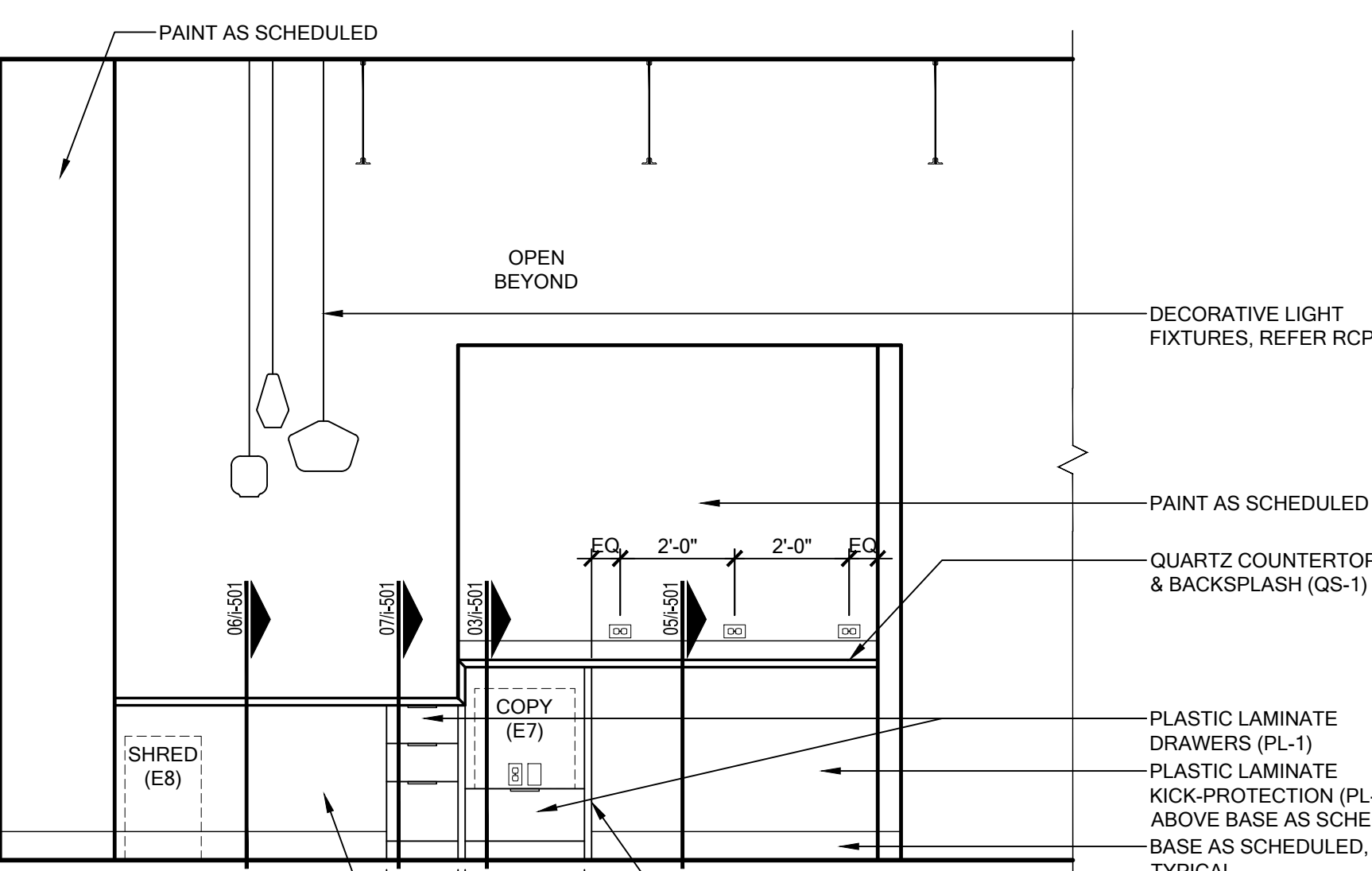

04 ELEVATION

File Name: I-700.DWG

SCALE: 3/8" = 1'-0"

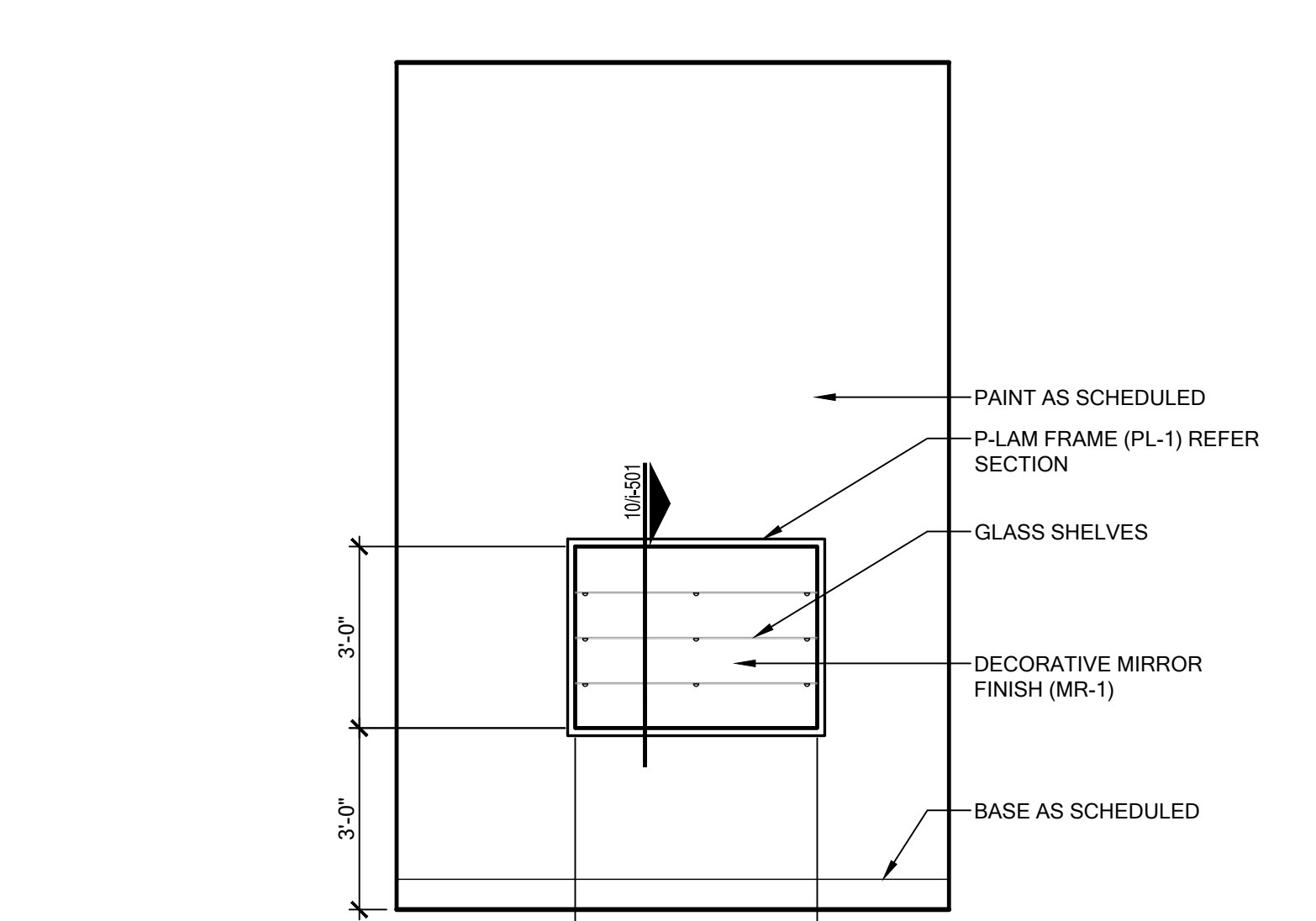

03 ELEVATION

File Name: I-700.DWG

SCALE: 3/8" = 1'-0"

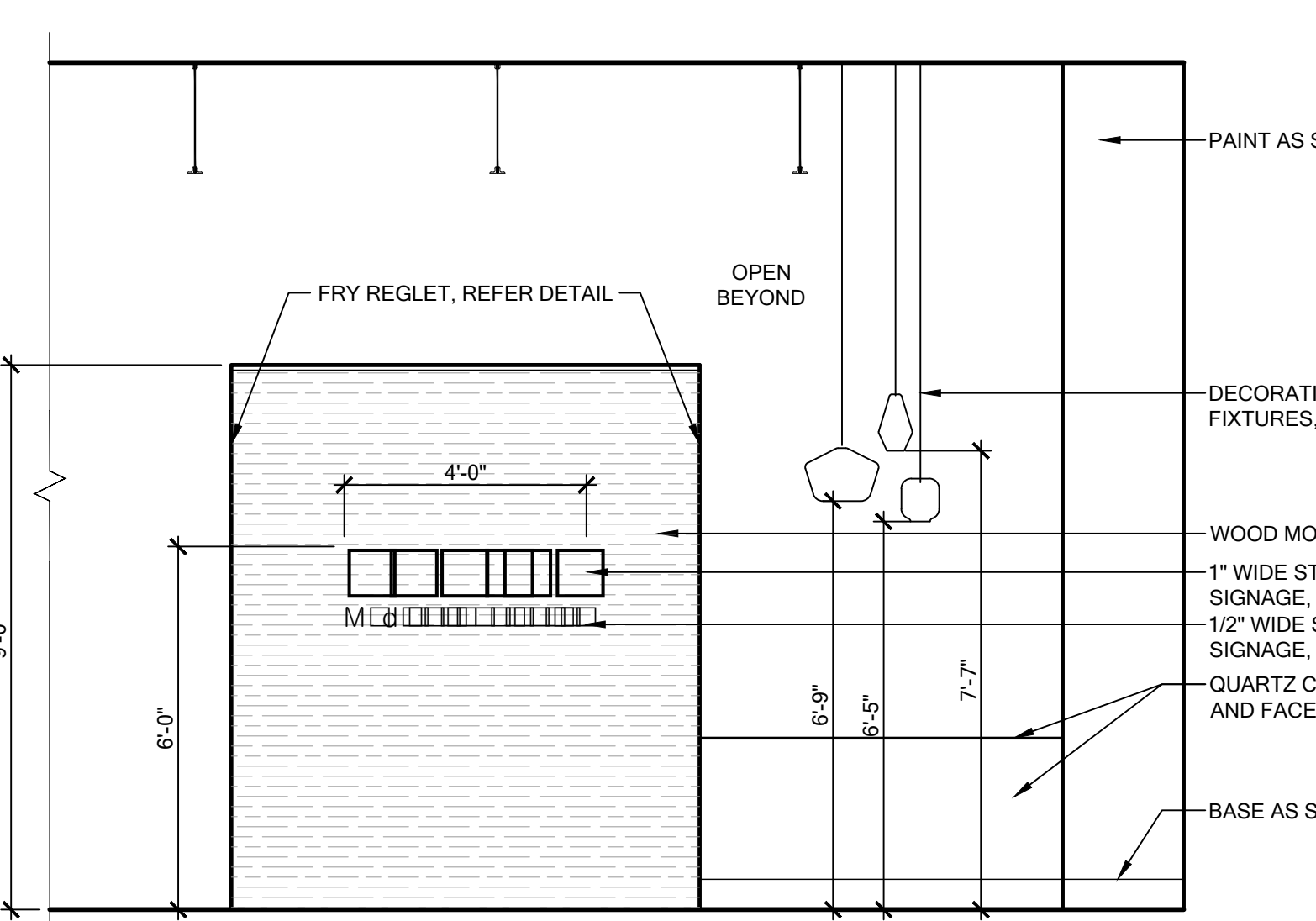

02 ELEVATION

File Name: I-700.DWG

SCALE: 3/8" = 1'-0"

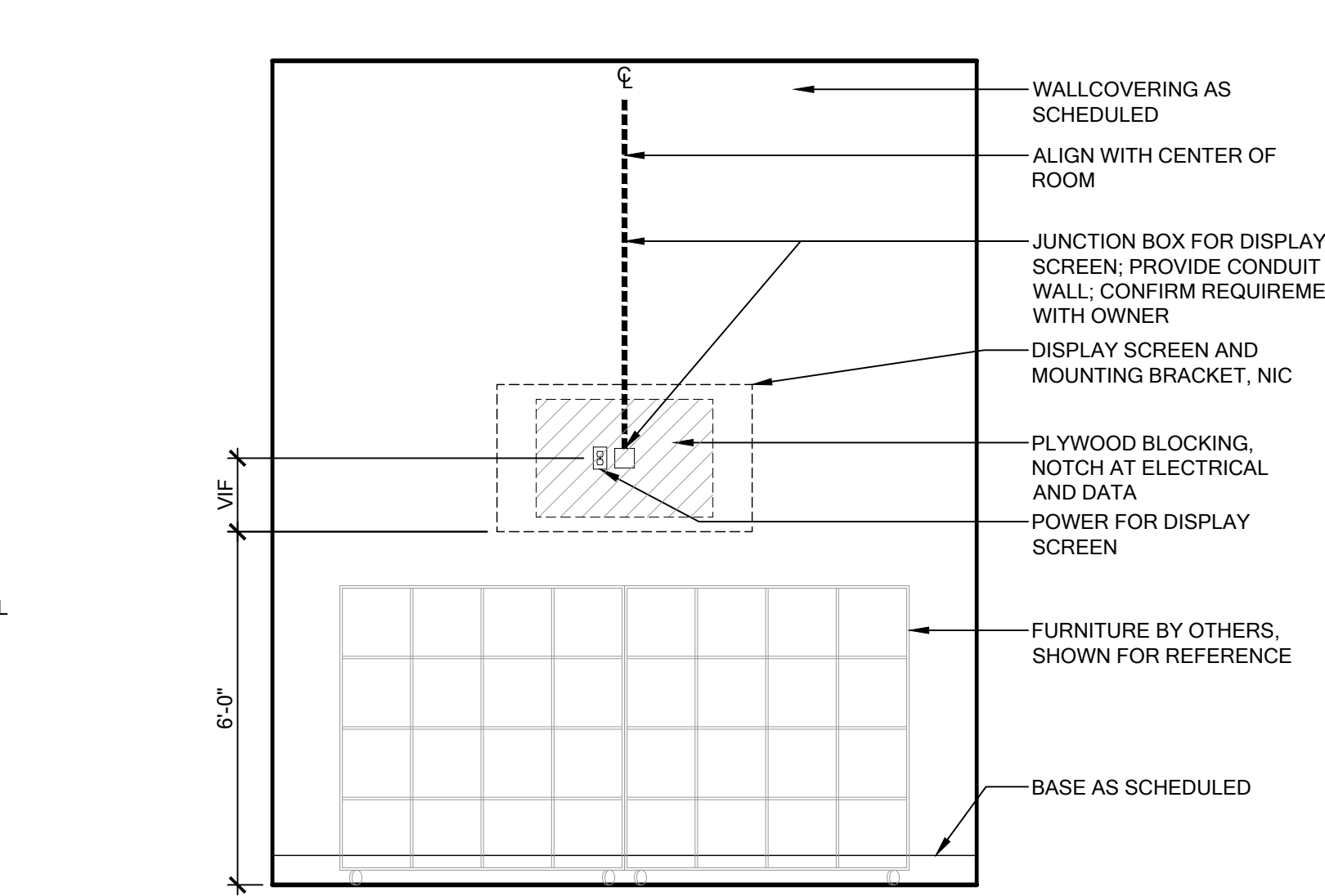

01 ELEVATION

File Name: I-700.DWG

SCALE: 3/8" = 1'-0"

FUSION MEDICAL AESTHETICS
THE FOUNDRY: WHEELHOUSE II
 2625 WHITMORE STREET, LEASE SPACE E
 FORT WORTH, TX 76107

INTERIORS



3300 West 7th Street, Suite 110
 Fort Worth, Texas 76107 | 817.303.1500
 2808 Fairmount Street, Suite 300
 Dallas, Texas 75201 | 214.303.1500

No.	Date	Revision

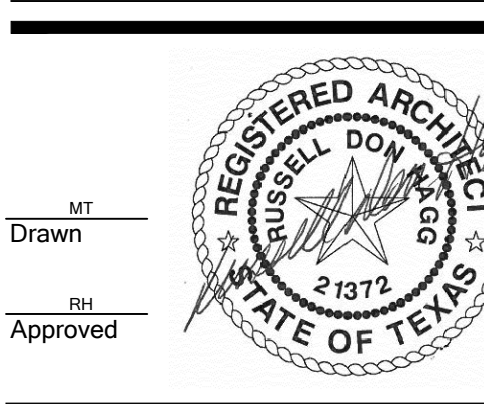

ELEVATIONS,
DOOR TYPES
& SCHEDULES

Project No. 17211.00
 Date 01.12.18

i-700